

## Technical Datasheet | Valve Optimix straight |

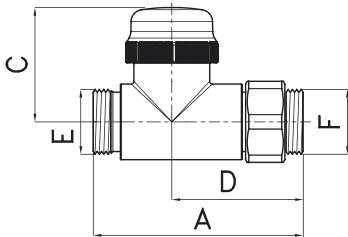

### General parameters I

Max. working pressure	10 bar
Max. working temperature	120°C
Body material	brass OT58
Connection	cooper or plastic pipes



A (mm)	C (mm)	D (mm)	E (mm)	F (mm)
84.5	42.5	44	M24 x 1/2"	1/2"

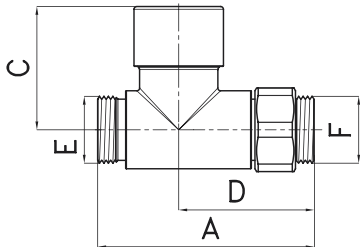

A (mm)	C (mm)	D (mm)	E (mm)	F (mm)
84.5	42.5	44	M24 x 1/2"	1/2"

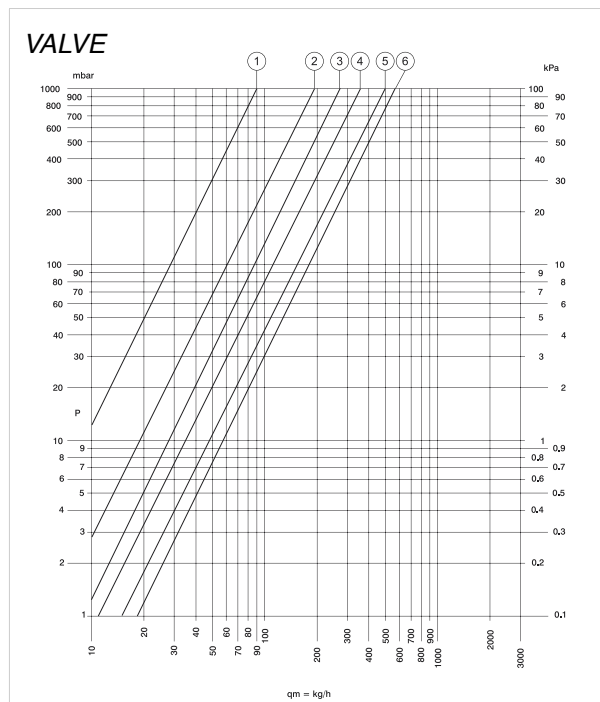

position	1	2	3	4	5	6
$K_V (+t = -2K)$	0,09	0,19	0,28	0,36	0,49	0,57
$K_{VS}$	0,09	0,19	0,30	0,41	0,66	0,85

*Kvs...using valve without thermostatic head |*

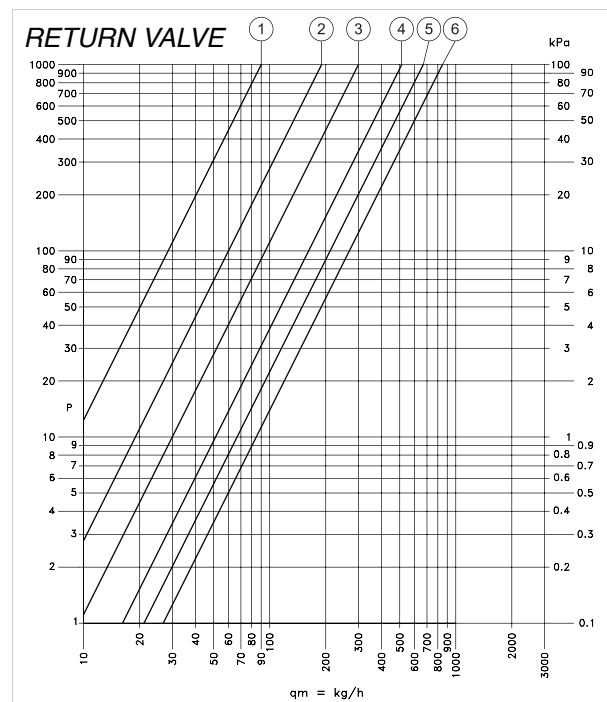

position	1	2	3	4	5	6
$K_{VS}$	0,09	0,19	0,30	0,41	0,66	0,85

**Technical Datasheet |  
Valve Optimix angled |**

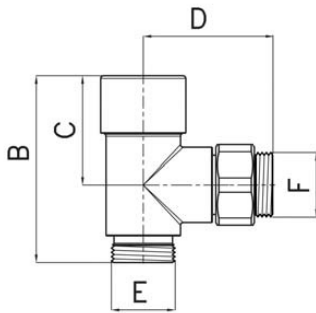
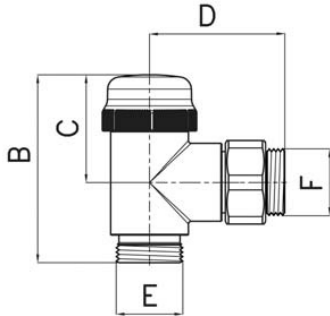

General parameters I	
Max. working pressure	10 bar
Max. working temperature	120°C
Body material	brass OT58
Connection	cooper or plastic pipes

B (mm)	C (mm)	D (mm)	E (mm)	F (mm)
68	39	44	M24 x 1/2"	1/2"

B (mm)	C (mm)	D (mm)	E (mm)	F (mm)
68	39	44	M24 x 1/2"	1/2"

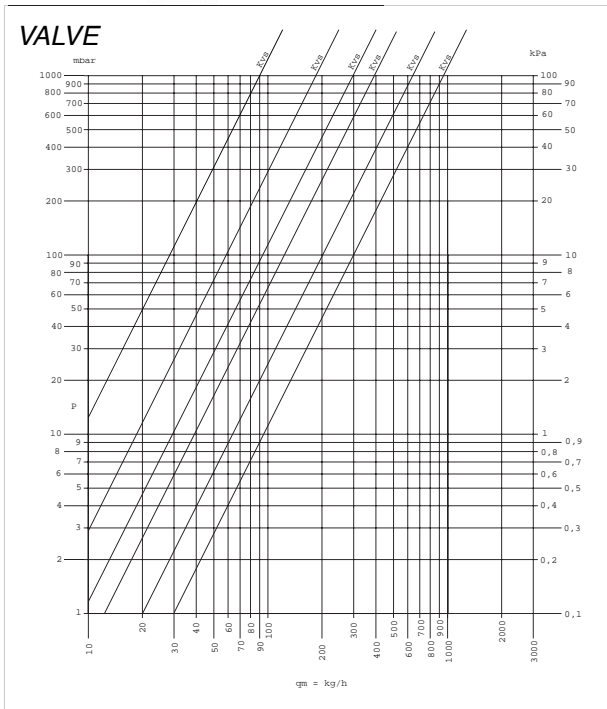

position	1	2	3	4	5	6
K <sub>vs</sub>	0,09	0,19	0,30	0,41	0,66	0,96

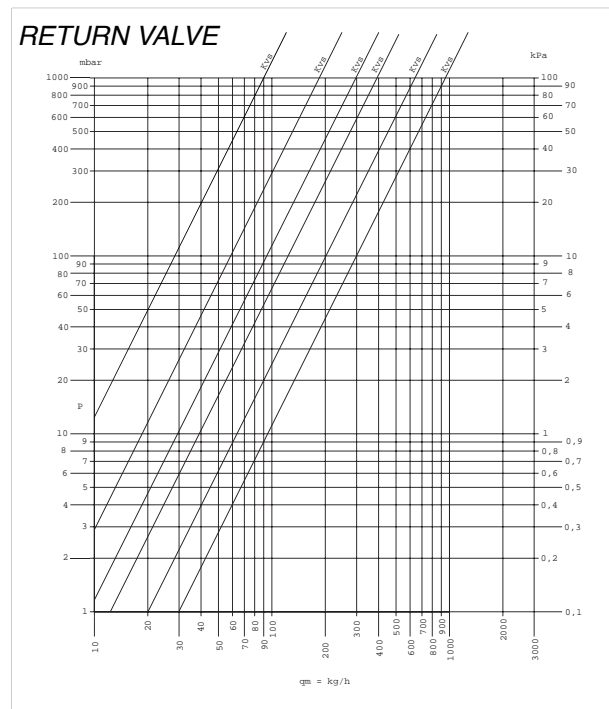

position	1	2	3	4	5	6
K <sub>vs</sub>	0,09	0,19	0,30	0,41	0,66	0,96

*Kvs...using valve without thermostatic head |*